

Corpus Christi Retirement Village

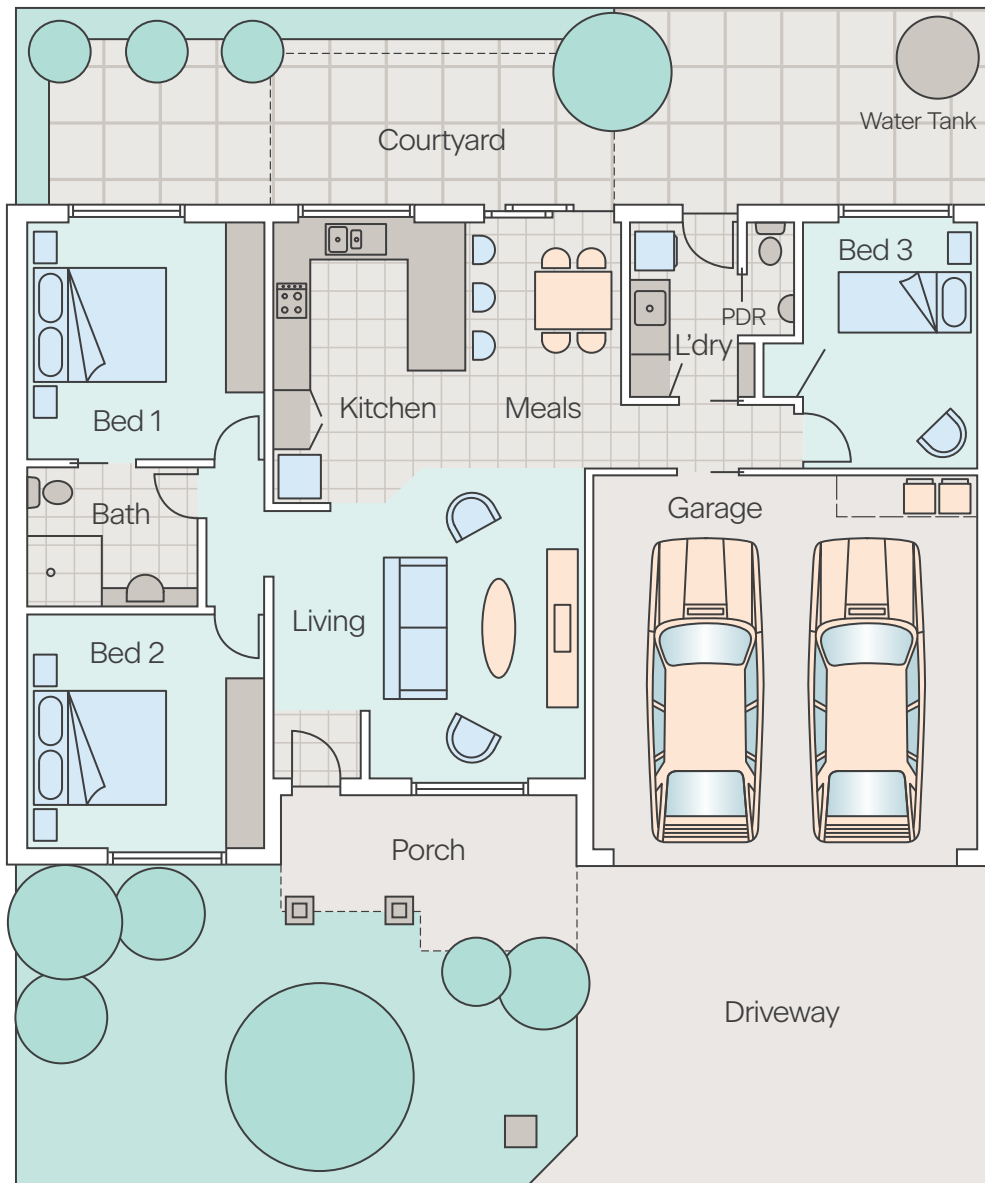

Approximate measurements

Internal area 102sqm

Bedroom 1
3.6m x 3.7m

Bedroom 2
3.6m x 3.6m

Bedroom 3 / Study
2.7m x 3.8m

Living Room
4.9m x 4.8m

Garage
6m x 6m

Disclaimer: There may be slight variations from the artist's impression shown. Furniture is not included. VMCH reserves the right to vary the plans and measurements at any time. We will provide any updated plans to interested purchasers.

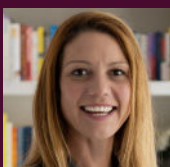

Please call Janelle for a private inspection.



(03) 8581 0600
hello@vmch.com.au
vmch.com.au/cc



VMCH